

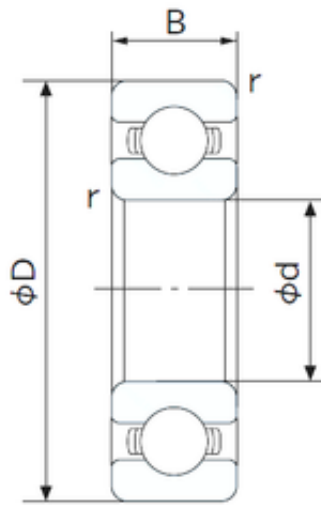

## BEARING PRECISION AXLE CORP.



6010 6011 6012 6013 6014 6015-O&Kai SKF  
NSK NTN NACHI Koyo Timken Z2V2 Z3V3  
Deep Groove Ball Bearing, OEM

Bearing No. 6010

Size	50x80x16 mm
Bore Diameter	50 mm
Outer Diameter	80 mm
Width	16 mm
d	50 mm
D	80 mm
B	16 mm
C	16 mm
r min.	1 mm
da min.	55 mm
Da max.	75 mm
ra max.	1.0 mm
Weight	0.264 Kg
Basic dynamic load rating (C)	21,8 kN
Basic static load rating (C0)	16,6 kN
(Grease) Lubrication Speed	8300 r/min
Category	Single Row Ball Bearings
Inventory	0.0
Manufacturer Name	NACHI
Minimum Buy Quantity	N/A
Weight / Kilogram	0
Product Group	B00308
Enclosure	Open
Precision Class	ABEC 1   ISO P0

6010 Bearing 2D drawings and 3D CAD models



## BEARING PRECISION AXLE CORP.

Maximum Capacity / Filling Slot	No
Rolling Element	Ball Bearing
Snap Ring	No
Internal Special Features	No
Cage Material	Steel
Internal Clearance	C0-Medium
Inch - Metric	Metric
Long Description	50MM Bore; 80MM Outside Diameter; 16MM Outer Race Width; Open; Ball Bearing; ABEC 1   ISO P0; No Filling Slot; No Snap Ring; No Internal Special Features; C0-Medium Internal Clearance; Steel Cage
Other Features	Deep Groove
Category	Single Row Ball Bearing
UNSPSC	31171504
Harmonized Tariff Code	8482.10.50.68
Noun	Bearing
Keyword String	Ball
Manufacturer URL	<a href="http://www.nachiamerica.com">http://www.nachiamerica.com</a>
Bore	1.969 Inch   50 Millimeter
Outer Race Width	0.63 Inch   16 Millimeter
Inner Race Width	0 Inch   0 Millimeter
Outside Diameter	3.15 Inch   80 Millimeter
Bore Type	Cylindrical Bore
Configuration	Single Row
Bore Size	50 mm
Width	16 mm
Fillet Radius/Chamfer	1 mm
Dynamic Load Rating	21,800 N



## BEARING PRECISION AXLE CORP.

Static Load Rating	16,600 N
Limiting Speed - Grease	8,500 rpm
Limiting Speed - Oil	10,000 rpm
Factor $f_0$	15.6
Radial Clearance	0.006 to 0.023 mm
da (min)	55 mm
Da (max)	75 mm
ra (max)	1 mm